

Finisher-J1 Installation Procedure

Follow the instructions in this booklet when installing the finisher to its host machine.

1 Unpacking

Open the shipping box of the finisher, and check to make sure that none of the components indicated in F1-1 is missing:

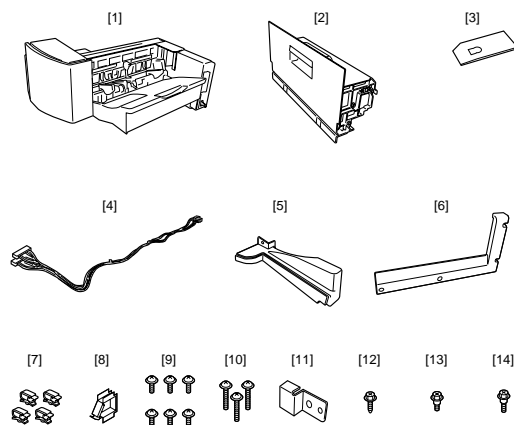

F1-1

[1]	Finisher -----	1 unit
[2]	Relay delivery assembly -----	1 pc.
[3]	Protective sheet -----	1 pc.
[4]	Rely harness -----	1 pc.
[5]	Right lower cover (for host machine) -----	1 pc.
[6]	Right cover (for host machine) -----	1 pc.
[7]	Wire saddle -----	4 pc.
[8]	Edge saddle -----	1 pc.
[9]	Screw (M4x8) -----	6 pc.
[10]	Screw (M4x16) -----	3 cp.
[11]	Connector cover -----	1 pc.
[12]	Self-tapping screw -----	1 cp.
[13]	Stepped screw (M4x2.5) -----	1 pc.
[14]	Stepped screw (M4xz3.; black) -----	1 pc.
[15]	Staple -----	1 box

2 Removing the Covers

1) Remove the left cover [1], right support cover [2], and right inside cover [3] of the host machine.
(These covers will not be used, but the screws used to hold the left cover in place and the stepped screws will be used later.)

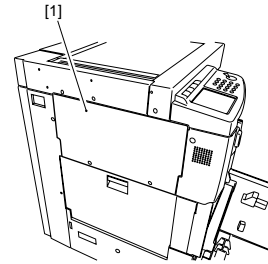

F2-1

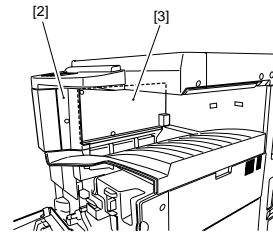

F2-2

2) Remove the support cover [1]. (Take care not to crack the claw of the support cover engaged with the support. The support cover will be used together with its mounting screws.)

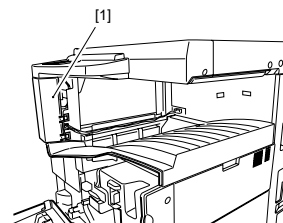

F2-3

3) Remove the six roller holders [1] together with the rollers and springs.

3-1) Push the rear of the roller holder with a flat-blade screwdriver, and shift it toward the delivery tray.

3-2) If the spring behind the roller holder is in the boss of the base, free the spring with a flat-bladed screwdriver.



After removing the roller holder, roller, and spring, be sure to count them (6 pc.), taking care not to leave any behind inside the machine. The roller holders, rollers, and springs will no longer be used.

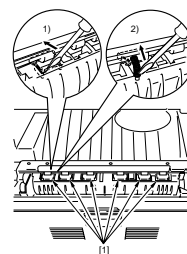

F2-4

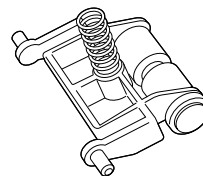

F2-5

4) Remove the two screws, and detach the delivery tray [1]. (The delivery tray will no longer be used, but the two screws will be used later.)

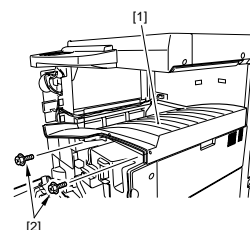

F2-6

3 Mounting the Relay Assembly

- 1) Fit the four wire saddles [1] to the stay of the host machine.
- 2) Fit the edge saddle [2] to the support of the host machine.

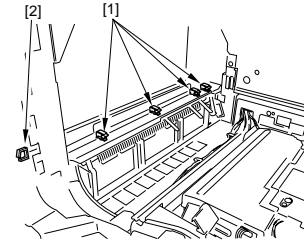

F3-1

- 3) Fit the relay harness. Connect the two connectors to the connectors inside the host machine, and lead the cable through the four wire saddles [2] and the edge saddle [2]. Do not connect the other end of the harness as yet.

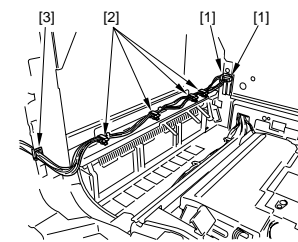

F3-2

4) Disconnect the connector [1] of the relay delivery assembly, and remove the clamp [2] of the cable fixing from the side plate.

5) Remove the tape [3] used to keep the cable in place and the tape [4] used to keep the stopper in place.

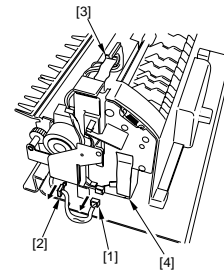

F3-3

6) Separate the relay delivery assembly into the top unit and the bottom unit.

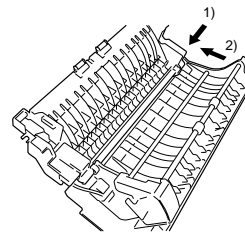

F3-4

7) Connect the harness [1] of the relay delivery assembly bottom unit to the host machine.

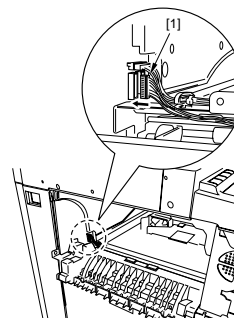

F3-5

8) Secure the relay delivery assembly bottom unit [1] to the host machine.

Use the two stepped screws (M4x2.5) [2] and three screws (M4x8) [3]. One of the stepped screws and one of the screws are the ones used to hold the left cover of the host machine in place.

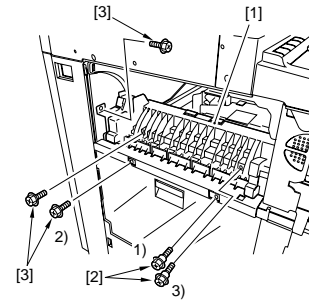

F3-6

9) Mount the relay delivery unit [1].

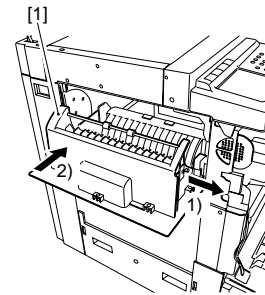

F3-7

10) Fix the open/close stopper [1] in place with a stepped screw (M4x3.3; black) [2].

11) Connect the connector of the relay delivery assembly (2P) [3], and fit the clamp [4] to the side plate.

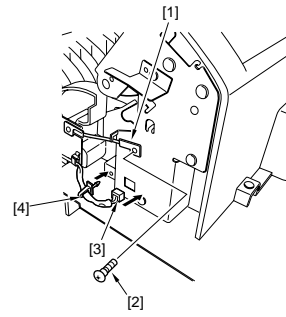

F3-8

12) Mount the connector cover [1] using the self-tapping screw [2].

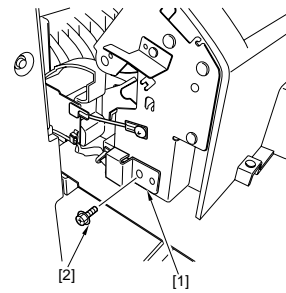

F3-9

4 Making Checks Before Installing to the Host Machine

1) Check to make sure that distance A between the top edge of the finisher's delivery tray rack [1] and the top edge of the rear frame [2] is $37 \pm 5\text{mm}$.

2) If not, turn the drive motor pulley [3] with your finger to adjust. At this point, be sure not to move the delivery tray [4] or apply force with your hand.

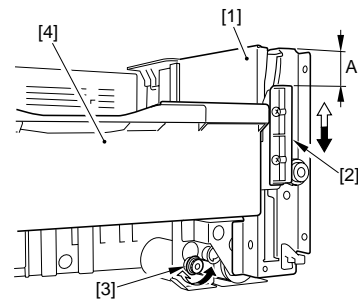

F4-1

5 Installing the Finisher

1) Attach the protective sheet [1] to the laser unit of the host machine. (Be sure to match the protective sheet against the marking line [2] on the laser unit.)

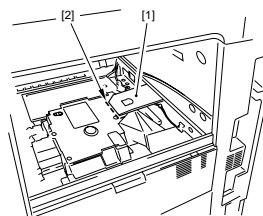

F5-1

2) Fit the finisher assembly [1] into the host machine as follows: holding the two grips (indicated by circles), lift the finisher assembly; engage the hook [2] of the finisher assembly on the right side plate of the host machine; then, slide the finisher assembly into the host machine.

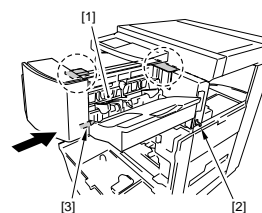

F5-2



Check to make sure that the pin [3] on the back of the finisher assembly matches the hole in the side plate of the host machine.

3) Fit the finisher assembly in place to the host machine: one M4x8 screw [1] and three M4x16 screws [2].

If you have difficulty in screwing due to the restricted movement in limited work space, turn the drive motor pulley [1] with your finger to adjust the position of the delivery tray [2] in figure. At this point, be sure not to move the delivery tray or apply force with your hand.

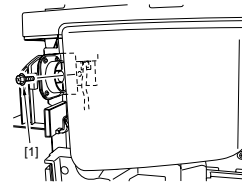

F5-3

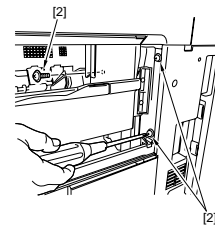

F5-4

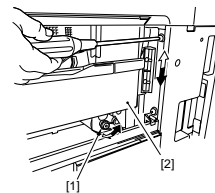

F5-5

4) Remove the staple cartridge [1] and the finisher assembly front cover [2]. (3 screws [3]; the staple cartridge, front cover, and screws will be used later.)

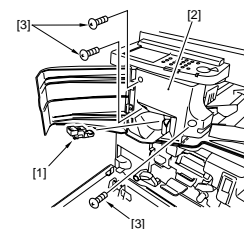

F5-6

- 5) Lead the relay harness through the cable clamp [1], edge saddle [2], and cable guide [3]. At this time, check to be sure that the relay harness is led through the left top corner of the cable guide.
- 6) Connect the connector [4] of the relay harness to the finisher controller PCB.

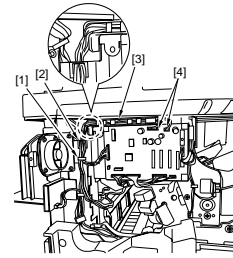

F5-7

6 Mounting the Covers

- 1) Mount the left front cover [1] of the host machine.
(Use the two screws (M4x8) [2] removed in step 2-4.)

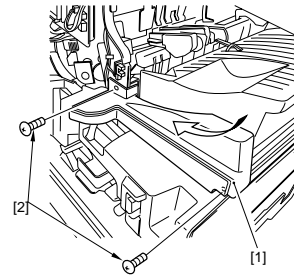

F6-1

- 2) Mount the right cover [1] of the host machine.
(Use the four screws (M4x8) [2].)

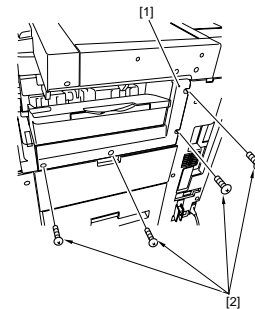

F6-2

- 3) Mount the support cover removed in step 2-2).
- 4) Mount the from cover of the finisher assembly
and the staple cartridge removed in step 5-4.